



# NanoZapp™

3 Watt Inline Ultra Violet Sterilizer



## **OWNER'S MANUAL**

TRANSWORLD AQUATIC ENTERPRISES INC.

# **NanoZapp**

## **Table of Contents**

<b>Important Safety Instructions</b>	<b>3–5</b>
<b>Parts</b>	<b>6</b>
<b>Introduction</b>	<b>7</b>
<b>Installation</b>	<b>8-9</b>
<b>Maintenance</b>	<b>10-11</b>
<b>Notes</b>	<b>12-13</b>

**NanoZapp**

# Important Safety Instructions

## **WARNING**

To guard against injury, basic safety precautions should be observed, including the following:

---

## **READ ALL SAFETY INSTRUCTIONS BEFORE USE.**

## **DANGER**

**UV EXPOSURE:** Do not operate lamp outside housing, direct exposure to UV rays can cause temporary reddening and irritation of eyes and skin.

To avoid possible electric shock, special care should be taken since water is employed in the use of aquarium equipment. For each of the following situations, do not attempt to repair yourself: return the appliance to an authorized service facility for service or discard the appliance.

- A. Carefully examine the UV appliance prior to installation. Since the lamp and quartz sleeve are fragile, they may have been damaged during transport.
- B. Do not operate the UV appliance if it has any breakage or cracks within the lamp or quartz sleeve.
- C. Do not operate the UV appliance if the UV lamp is not completely inserted into the quartz sleeve.
- D. Close supervision is necessary when any appliance is used by or near children.
- E. Always unplug the unit from an outlet when not in use, before servicing, and cleaning or making adjustments to the pump.

## Important Safety Instructions

F. To avoid the possibility of the appliance plug or receptacle getting wet, position aquarium stand and tank to one side of a wall mounted receptacle to prevent water from dripping onto the receptacle or plug. A "drip loop", shown in the Figure at the right should be arranged by the user for each cord connecting an aquarium appliance to a receptacle. The "drip loop" is that part of the cord below the level of the receptacle or the connector if an extension cord is used, to prevent water travel along the cord and coming in contact with the receptacle. If the plug or the receptacle do get wet, DON'T unplug the cord. Disconnect the fuse to the circuit breaker that supplies power to the appliance. Then unplug and examine for the presence of water in the receptacle.

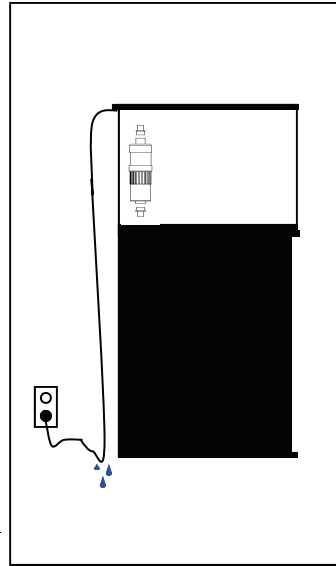

G... To avoid injury, do not contact moving parts or hot parts such as heaters, reflectors, lamp bulbs, and etc.

H. Always unplug an appliance from the outlet when not in use, before putting on or taking off parts, and before cleaning. Never yank the cord to pull plug from the outlet. Grasp the plug and pull to disconnect

I. Do not use an appliance for other than intended use. The use of attachments not recommended or sold by the appliance manufacturer may cause an unsafe condition.

J. Do not install or store the appliance where it will be exposed to the weather or to temperatures below freezing.

## **Important Safety Instructions**

J. Make sure an appliance mounted within the tank is securely installed before operating it.

K. Read and observe all the important notices on the appliance.

L. This appliance has a polarized plug (one blade is wider than the other). As a safety feature, this plug will fit in a polarized outlet only one way. If the plug does not fit fully in the outlet, reverse the plug. If it still does not fit, contact a qualified electrician. Never use with an extension cord unless plug can be fully inserted. Do not attempt to defeat this safety feature.

M. If an extension cord is necessary, a cord with a proper rating should be used. A cord rated for less amperes or watts than the appliance rating may overheat. Care should be taken to arrange the cord so that it will not be tripped over or pulled.

### **CLEANING**

It is important to keep this appliance clean. Always unplug the appliance before performing maintenance or cleaning of the pre-filter sponge, pump, and quartz sleeve. . Make sure hands are completely dry before re-plugging into an electrical outlet.

### **SERVICING**

In order to assure proper electrical connections and polarity, replacement parts and servicing should be performed only by a qualified electrician.

### **OPERATION**

Please carefully read the entire "Owner's Manual" for proper operation procedures before proceeding with turning on this appliance and adding livestock such as fish, corals, and invertebrates.

**SAVE THESE INSTRUCTIONS**

# NanoZapp Parts

## PARTS EXPLODED VIEW & IDENTIFICATION

Description	Part #
Transformer Body	MT-NZ-1
3 Watt UV-C Lamp G5.3 Bi Pin Base	MT-NZ-2
Quartz Sleeve	MT-NZ-3
O-Ring (Orange )	MT-NZ-4
O-Ring (Black )	MT-NZ-5
Quartz Sleeve Cover	MT-NZ-6
6" - 1/2" Flexible Tubing	MT-NZ-7
6" - 1/2" Flexible Tubing	MT-NZ-8

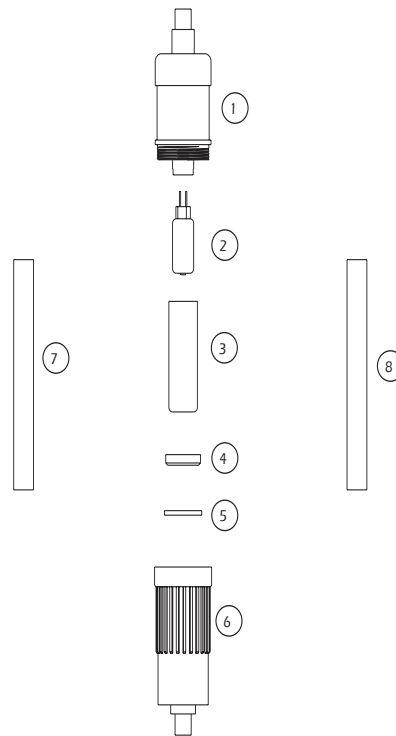

### **Innovative Algae & Disease Control**

Thank you for purchasing the NanoZapp™, the smallest inline ultra-violet sterilizer to date. This miniature version was specifically designed for eradicating harmful micro-organisms and unattractive green free-floating algae in fresh & saltwater aquariums less than 30 gallons. This revolutionary UV sterilizer/clarifier is completely submersible, which can be placed discreetly behind the filter walls of most nano aquariums without ever being seen.

The NanoZapp™ utilizes a UV-C G5.3 bi-pin lamp that is encapsulated in our unique Quartz Sleeve that is air tight and allows for a 99% transmission rate to efficiently neutralize disease causing pathogens. Simply, connect to your existing pump and you are ready to go.

### **Intelligent Design**



**CAUTION:**

Never look directly at the UV-C Lamp, ultraviolet radiation can be harmful. Always unplug before making adjustments.

# NanoZapp Installation

**CAUTION: Inspect UV Lamp & Quartz Sleeve Prior to Installation.**

Do not allow children to operate this aquarium appliance. Do not operate if appliance has a damaged cord or plug.

## Initial Inspection - For breakage

Upon receiving this product please untighten the quartz sleeve cover and inspect the quartz sleeve and lamp for any damage.

Close attention should be observed to the UV lamp & Quartz Sleeve prior to use.

Please contact your authorized dealer if your product is found damaged.



## Installation into JBJ 28g Nano Cube Series

The NanoZapp™ is the perfect compliment to our #1 selling 28g Nano-Cube Aquarium, enjoy the benefits of sterilization while being discreetly hidden.

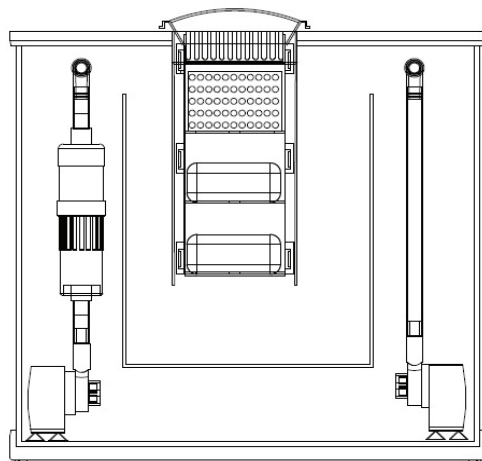

1. Remove one of the pumps.
2. Measure and cut included hose
3. Connect NanoZapp to hose
4. Plug into electrical outlet.

**Note:** Do Not Plug the pump connected to the NanoZapp back into the Ocean Pulse Wavemaker.

Plug into a separate outlet as the sterilizer requires a constant flow of water.



# NanoZapp Installation

## Installation into a Non JBJ Nano-Cube

The NanoZapp™ was designed for the 28g Nano Cube Aquarium. But is so versatile that it can be used with most nano aquariums in the market. Each end of the sterilizer are installed with 1/2" diameter connectors.

The total length of the NanoZapp™ is 8 inches, remove your existing pump/hose and connect securely.

You will need to measure and cut the included 1/2" hose.

Flow Rate: Requires a flow rate of 100-225 gallons per hour.

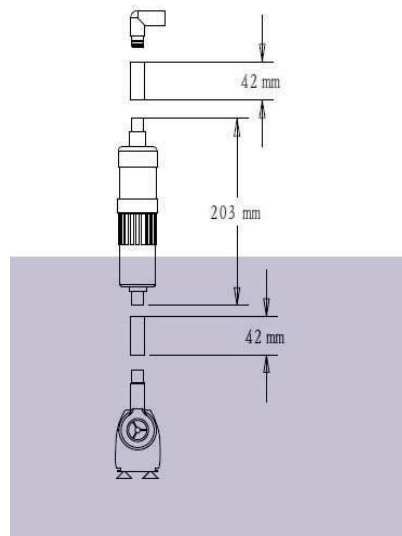

## Cleaning the Quartz Sleeve –Monthly

The Quartz Sleeve acts as a barrier between the water and the UV-C lamp to maintain proper operating temperatures and allow for a 99% transmission rate.

Cleaning the Quartz Sleeve is crucial to the UV's success and should be performed monthly.

Step 1: Unplug pump and NanoZapp™ from electrical outlet

Step 2: Unscrew the black quartz sleeve cover (counter clockwise)

Step 3: Clean any unwanted algae and debris from the outside of the quartz sleeve.

**Note:** Vinegar may be used to remove calcium deposits on the exterior of the quartz sleeve. Clean residual off before re-installing

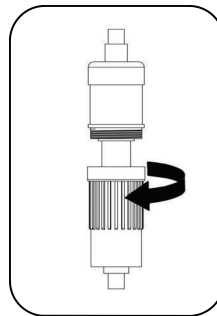

### Replacing the UV-C Lamp— 6 to 9 months

The UV-C lamp has an average life span of 5000 hours of operation. Although the lamp may illuminate, it will not perform effectively for disease control. Lamp should be replaced before it expires.

You can check the status of the lamp by an illuminated blue color at the bottom of the NanoZapp™.



### Replacing the UV-C Lamp

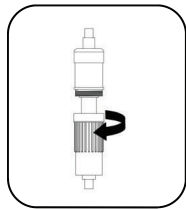

Step 1: Twist off black quartz sleeve cover (counter clockwise)

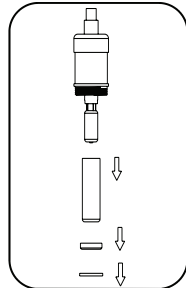

Step 2: Gently pull quartz sleeve out.

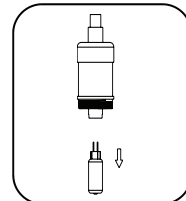

Step 3: Unplug the UV-C lamp and plug in new lamp.

# NanoZapp

---

## Recommended Maintenance

Model	MT-NZ3
UV Lamp	G5.3 PI BIN (3 Watt)
Volts/Hz	AC110V/60Hz
Pump Flow: Required	100 to 225 GPH
Aquarium Capacity	30 Gallons
Life Of UV Lamp	Approx. 5000 hrs
Avg. Quartz Sleeve Cleaning Schedule	Every Month
Wavelength	253.7 nm
Dimensions	8" x 1.5" x 1.5"

### Customer Service Information

For additional information or technical support, please call us at (877) 374-9981 , M-F from 9AM-5PM (Pacific Standard Time).

# **NanoZapp** **Notes**

---



**TransWorld Aquatic Enterprises, Inc**

3730 W. Century Blvd #3  
Inglewood, CA 90303

Phone: (877) 374-9981

Visit us at [www.jbjlighting.com](http://www.jbjlighting.com)